

PICTORIAL VIEW

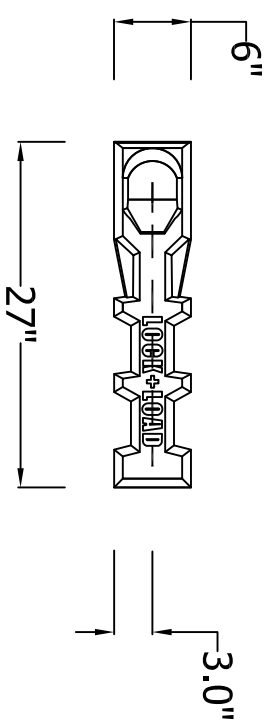

TOP VIEW

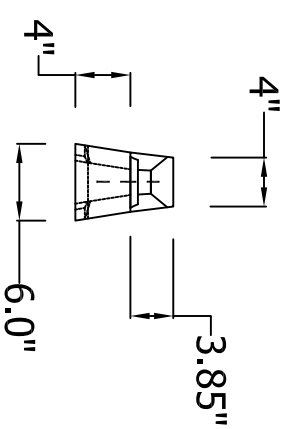

REAR VIEW

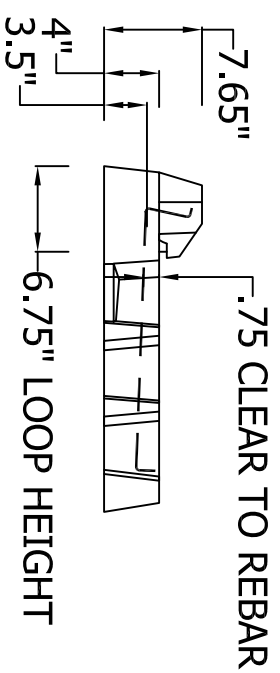

SIDE VIEW

NOTE:

- 1) MINIMUM CONCRETE COMPRESSIVE STRENGTH AT 28 DAYS 5500 PSI 42 mpa
- 2) 6% AIR ENTRAINMENT
- 3) 3 LBS STRUCTURAL FIBER PER CUBIC YARD

REV #	DESCRIPTION	DATE

**LOGK+LOAD**<sup>TM</sup>  
**RETAINING WALL SYSTEMS**  
 1681 CHESTNUT STREET, SUITE 400, VANCOUVER, B.C. V6J 4M6  
 Tel: (604) 732-5959 Fax: (604) 737-1140  
 Web site: www.logk-load.com

DRAWING NAME: STANDARD COUNTERFORT	
CITY:	COUNTRY:
DRAWN BY:	DATE: 01/06/12
APPROVED BY:	PREPARED FOR:
SCALE: N.T.S.	OUR PROJECT NUMBER:
OUR DRAWING NUMBER:	STANDARD COUNTERFORT